

Medical Photography

Information for patients and carers

Dermatology

What is the service?

The Medical Illustration Department takes professional medical photographs of skin rashes and lesions. They can also provide measurements and view the skin with a dermatoscope if needed. A dermatoscope allows for inspection of skin lesions unobstructed by skin surface reflections. The images can be captured digitally or as a video recording.

What are the benefits of the service?

If you have a skin rash or any lesions the medical photographs act as a baseline for future reference. They also help guide the best location for taking biopsies if this is necessary. The healthcare team involved in looking after you, also use them to discuss your care.

How can I access the service?

Your dermatology (skin) doctor will ask you to sign a consent form for medical photographs. You will then take the form with you to the Medical Illustration Department where the photographs will be taken.

The Medical Illustration Department can be found in the main hospital block please use the included map and instructions to find your way.

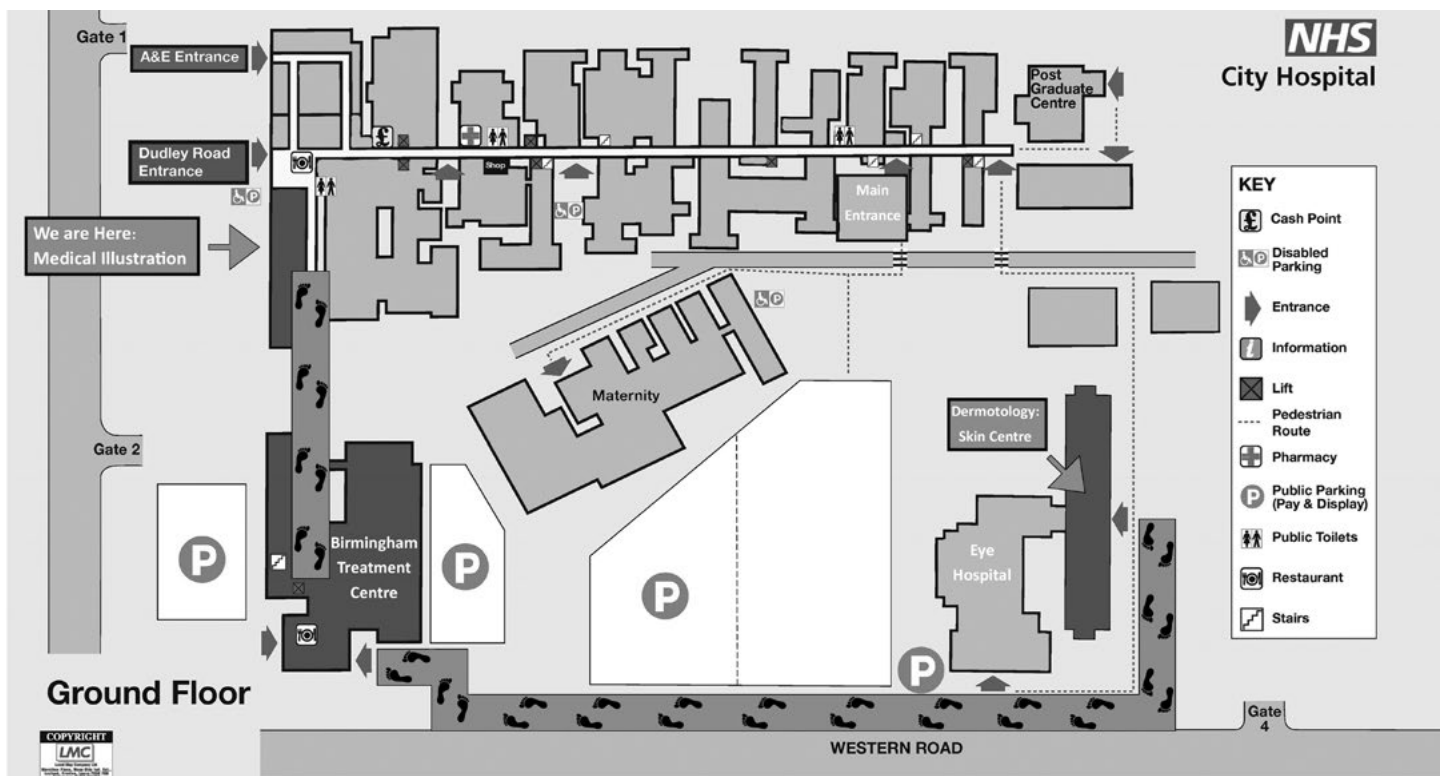

Medical Photography

Information for patients and carers

Dermatology

Follow the footsteps on the map above:

1. Turn right out of the skin centre main entrance (Sheldon Block).
2. Follow the path until you reach the road.
3. Take another right turn following the road until you reach the Birmingham Treatment Centre (BTC).
4. Go into the BTC and take the escalators, lift or stairs to the 1st floor.
5. Follow the main corridor past the fracture clinic towards the main hospital, keep going through the link corridor until you reach medical illustration.
6. Please ring the bell and take a seat outside if the door is closed. If the door is open take a seat in the waiting room.

The medical photography service is a free service and does not need to be booked in advance.

Opening hours

The Medical Illustration Department is open:

Monday to Friday 9am-1pm & 1:30pm-5pm

Contact details

Medical Illustration Team

City hospital

Telephone: 0121 507 4662

If you would like to suggest any amendments or improvements to this leaflet please contact SWB Library Services on ext 3587 or email swbh.library@nhs.net.



A Teaching Trust of The University of Birmingham
Incorporating City, Sandwell and Rowley Regis Hospitals
© Sandwell and West Birmingham Hospitals NHS Trust

ML6744

Issue Date: July 2022

Review Date: July 2025